

Installation Manual

600000E

GR3 & GR4-Series Guide Rail Systems

Models

GR3-Series 3" Pump Disconnect

- For use with 3" Horizontal Discharge Pumps
- 3" ANSI Bolt Pattern
- Available as:
 - *GR3* for ordinary locations
 - *GR3NS* for hazardous locations

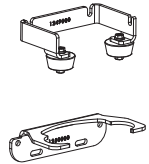

GR4-Series 4" Pump Disconnect

- For use with 4" Horizontal Discharge Pumps
- 4" ANSI Bolt Pattern
- Available as:
 - *GR4* for ordinary locations
 - *GR4NS* for hazardous locations

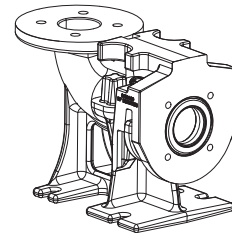

GR3 BASE

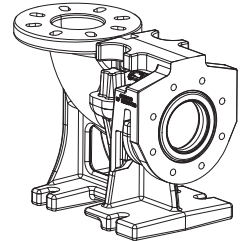

GR4 BASE

Features

- Accommodates dual 2" guide rails
- Auto-alignment feature
- Upper and mid-rail support bracket
- Includes double nitrile sealing grommet

IMPORTANT: All Liberty Pumps systems are supplied with their own separate Installation/Operation/Maintenance manuals. Ensure receipt of these manuals, and that they are read and understood prior to installation. For questions, call Liberty Pumps customer service at 1-800-543-2550.

NOTICE

Installer: Manual must remain with owner or system operator/maintainer.

Record information:

System: _____

Model(s): _____

Serial(s): _____

Mfg Date: _____

Install Date: _____

7000 Apple Tree Avenue
Bergen, NY 14416
ph: 1-800-543-2550
fax: 1-585-494-1839
www.LibertyPumps.com

Keep this manual handy for future reference.

For replacement manual, visit LibertyPumps.com,
or contact Liberty Pumps at 1-800-543-2550.

Retain dated sales receipt for warranty.

GR3/GR4-Series Assembly

The GR3/GR4-Series quick pump disconnect assemblies are designed to allow easy pump installation and removal. When installed correctly, the guide rail assembly creates a tight discharge seal and provides a means to lift the pump without disconnecting any of the discharge piping. Ensure that installation is done per instructions.

The guide rail system consists of three parts: Support Brackets, Mounting Claw, and Base.

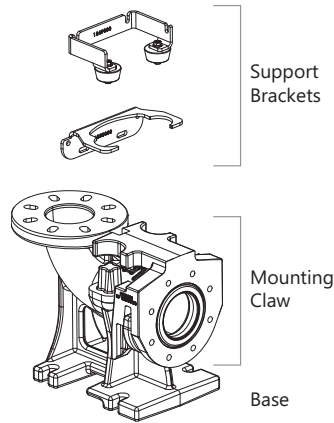

Support brackets: Two support brackets guide and support the dual 2" (50 mm) guide rail pipes. *Pipes are not included; galvanized or stainless steel is recommended.*

The upper support bracket is used to locate the guide pipes over the guide rail base, while the mid-rail support bracket is used to limit guide pipe movement when using the guide rail.

Place the mid-rail support bracket roughly in the middle of the guide rail pipe span. The support bracket needs to be mounted to a support structure, bar stock, angle iron, or other secure means that attaches to the sidewalls of the vault.

Place the upper rail support bracket at top of vault, mounting to secure vault structure. Once installed, tighten upper rail support top nuts.

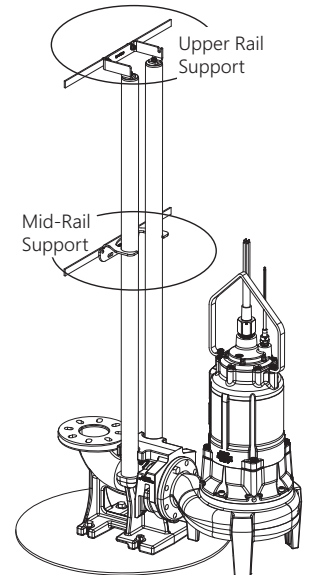

Preparation

All claws have a sealing grommet that provides the seal between the claw and base, and also the seal between the claw and the pump.

Insert grommet into claw, then apply a light amount of sealing grease (provided) to the face of the grommet that sits on the guide rail base.

- ① Insert grommet into claw
- ② Grease grommet sealing faces

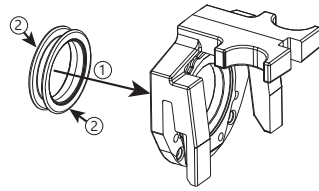

Installation

Base: Mount the base to the floor of the pumping chamber or vault, referring to the **Base Mounting Template** measurements. Secure the base to the vault floor at the base slots. When mounting to a concrete surface, use 1/2" or 5/8" (14 or 16 mm) thread wedge anchors.

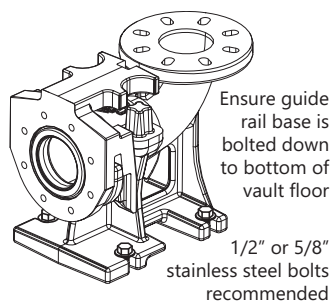

Pump Mounting Claw: The claw allows 3" or 4" solids handling.

Using supplied bolts, mount the claw onto the pump discharge. The claws mate to a 3" or 4" ANSI 150 bolt pattern (per model selected).

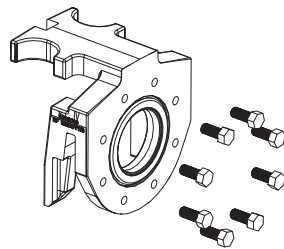

Operation

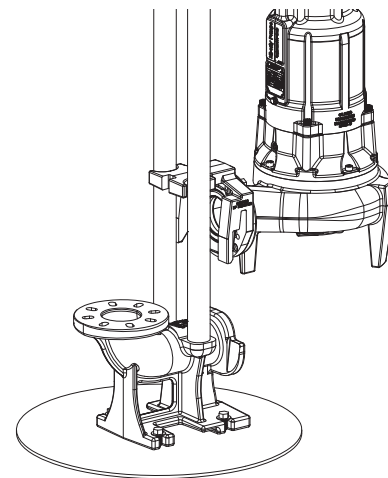

Disconnected Position

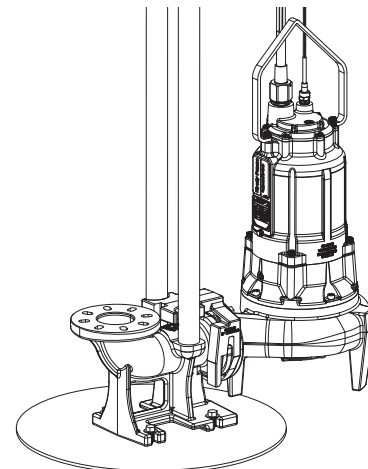

Operating Position

This page intentionally left blank.

Esta página se dejó en blanco intencionalmente.

Cette page a été laissée vide intentionnellement.

Base Mounting Template

Plantilla de montaje de la base

Gabarit de montage de base

